

Specification for monolithic crystal filter series **MQF 118.....137 -2500/R**

**1. General**

1.1. Package:

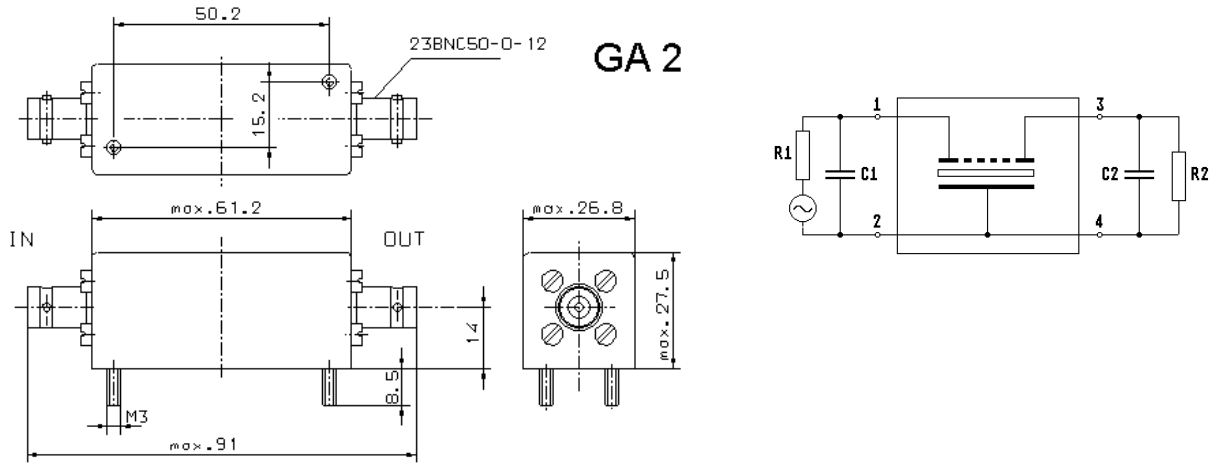

- |                                   |                    |
|-----------------------------------|--------------------|
| 1.2. Type name:                   | MQF 1xx.xxx-2500/R |
| 1.3. Number of poles:             | 4                  |
| 1.4. Operating temperature range: | -20°C to +70°C     |
| 1.5. Storage temperature range:   | -35°C to +85°C     |
- 2. Electric values**
- |  |   |
|--|---|
| 2.1. Nominal center frequency fo:  | 118.....137 MHz<br>T.B.D. by customer for each order                |
| <b>2.2. Pass band</b>  |   |
| 2.2.1. Bandwidth between 3 dB - frequencies:   | > fo ± 12.5 kHz   |
| 2.2.2. Ripple:   | < 1.0 dB at fo ± 8.0 kHz  |
| 2.2.3. Insertion loss:<br>( measured on smallest attenuation in pass band )                          | < 4.0 dB  |
| <b>2.3. Stop band</b>  |   |
| 2.3.1. fo ± 60 kHz   | > 40 dB   |
| 2.3.2. fo ± 90 kHz   | > 55 dB except spurious   |
| 2.3.3. Alternate attenuation   | > 55 dB except spurious   |
| 2.4. Terminating impedance ( input and output ):   | 50 Ω // 0 pF  |
| 2.5. Maximum input power level:  | -10 / +10 ( working / non-damaged )                                 |
| 2.6. Out band Intermodulation with test tones f1/f2 at fo ±100 / ±200 kHz and input power of -10 dBm | > 78 dB down from each of both -10 dBm test tones ( IP3 > +29 dBm ) |

3. Marking:

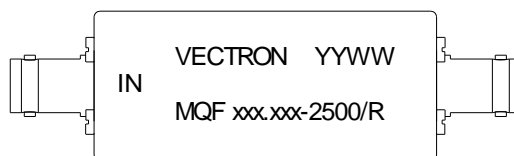

e.g. for center frequency of 121.5 MHz the filter part description is MQF 121.5-2500/R

- |                            |   |
|----------------------------|---|
| 4. Environment conditions: | Corresponding to Vectron standard CF001 |
|----------------------------|---|

Edited by: \_\_\_\_\_ date: \_\_\_\_\_ name: \_\_\_\_\_