

# Rocker Switches

## 21 x 15 mm DP Rocker Switch

## RK5 Series

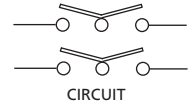
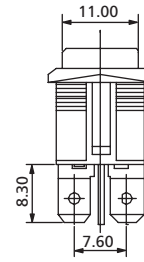
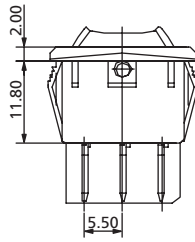
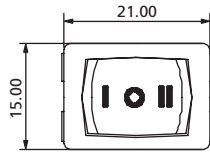

**RK5D3Q4\_ \_ \_ \_ N ON-OFF-ON**

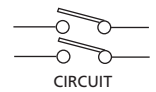
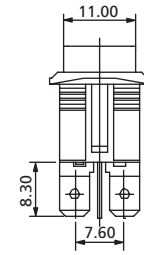
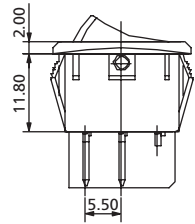
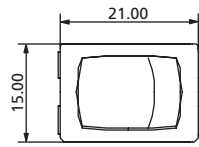

**RK5D1Q4\_ \_ \_ \_ N ON-OFF**

### TERMINAL

### ACTUATOR

### ACTUATOR MARKING

### PANEL SIZE

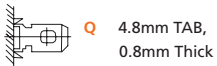

4 Curve  
(No Illuminated)

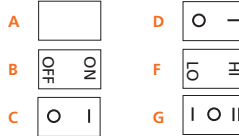

PANEL CUT-OUT  
Snap-in mounting

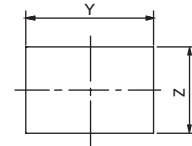

X (Panel thickness)	Dimension Y	Dimension Z
0.75 to 1.25 mm	19.20 +0.1/-0 mm	12.90 +0.15/-0 mm
1.25 to 2 mm	19.40 +0.1/-0 mm	12.90 +0.15/-0 mm
2 to 3 mm	19.80 +0.1/-0 mm	12.90 +0.15/-0 mm

## How to order:

RK5

**1 POLES:**  
D Double Poles

**2 SWITCHING:**  
1 ON - OFF  
2 ON - ON  
3 ON - OFF - ON  
4 MOM - OFF  
5 MOM - ON

**3 TERMINAL (See above drawings):**  
Q 4.8mm TAB, 0.8mm THICK  
D Solder Tag

**4 ACTUATOR (See above drawings):**  
4 Curve

**5 ACTUATOR MARKING:**  
A See above drawings  
B See above drawings  
C See above drawings  
D See above drawings  
F See above drawings  
G See above drawings

**6 BASE COLOR:**  
A Black  
H Grey  
B White

**7 ACTUATOR COLOR:**  
A Black  
H Grey  
B White  
C Red

**8 WATERPROOF COVER:**  
N None Cover (Standard)  
W With Waterproof Cover

## General Specifications:

### FEATURES

- » Double pole rocker switch up to 10(4)A 250VAC
- » Non-illuminated

### MATERIALS

- » Contact Arm: Silver plated copper alloy
- » Terminal: Silver plated copper
- » Spring: Piano wire

### MECHANICAL

- » Temperature Range: -20°C to +85°C

### ELECTRICAL

- » Electrical Life: 10,000 cycles
- » Rating: 13A125VAC / 10A250VAC / 1/2HP 125/250VAC / 10A125/250VAC / 10(4)A250VAC- μT85

- » Initial Contact Resistance: 20mΩ max.
- » Insulation Resistance: 100MΩ min. at 500VDC